



OPTIONS

Guide

2023/2024

Table of Contents

Interior Options

Evermore Custom Cabinetry	3
Kitchens	
Cabinets	4-5
Sinks	6
Backsplash	7
Fireplaces	8
Built-In Components	9
Bathrooms	
Sinks & Vanities	10-11
Tubs & Showers	12-13
Faucets	14
inHouse Experience	15
Lighting	16-17
Interior Doors & Trim	18
Walls & Entertainment Centers	19
Utility Room	20
Attic Access, Ceilings & Soffits	21



Shown with: Twin Peak Dormer with Bumpout & Full Eave, 10' Dormer with full eave and Bumpout 74, White Vertical & Shake Siding, Market Square Dutch Lap Siding, Window Lineals, 2-Panel Half Lite Element Glass Front Door & 4-Lite with Glass Rear Door.

Commodore Homes of Indiana offers many optional features for you to personalize your home. This brochure represents a sample of the choices we offer. Ask your sales representative for more details on additional options and choices available.

Exterior Options

Siding & Porches	22
Doors	23
Windows	24-25
Dormers	26-27



*Colors Shown May Not Represent Current Offering

CABINETY SELECTIONS



French Country Oak Mission Flat Panel



Rustic Elm Oak Mission Flat Panel



Hickory Mission Flat Panel



Shadow Grey Painted Mission Flat Panel



Deep Blue Painted Mission Flat Panel



White Painted Mission Flat Panel

INTERIOR KITCHEN



Chef's Choice Range Hood
Available in Stainless Steel & Black



Wall Oven and Surface Unit
Prep Available for Microwave at Pantry
Stainless Steel Only, Black N/A



**Pull out Trash Container
Drawer**



Crescent-Edge Countertops



Craftsman Range Hood



Glass Door Insert
(Glass Style may vary)



42" Height Overhead Cabinets



Pull-Out Shelves in Base Cabinets
Pulls Out on Bottom



3/4 Corner Lazy Susan
Where Available



Undermount Soft Close Drawer Guides

Cabinet Profiles



42" Overhead (Standard Choice)



Ship Lap Accent on Back of Island
Colors Available: Grey and White. Island Legs N/A



City Scope (Standard Choice)



Century Cabinet Crown w/ Soffit (Optional)

KITCHEN SINKS



33x22x8 Stainless Steel Sink



Drop-In Double Bowl Black Stainless Sink



Curved Front Stainless Steel Farmers Sink - *Shown with optional Gooseneck Pull Down Faucet*



Galley Sink - Includes: 27X19X10 Galley Sink, Brushed Nickel & Black Coil Spring Faucet w/Pull Out Sprayer, Mini Bowl, Colander, Sink Cover, Chopping Board, & Strainer



Curved Front Black Stainless Steel Farmers Sink

KITCHEN BACKSPLASH

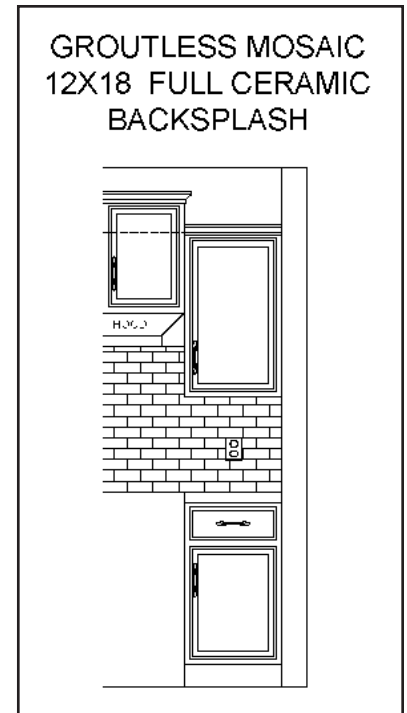
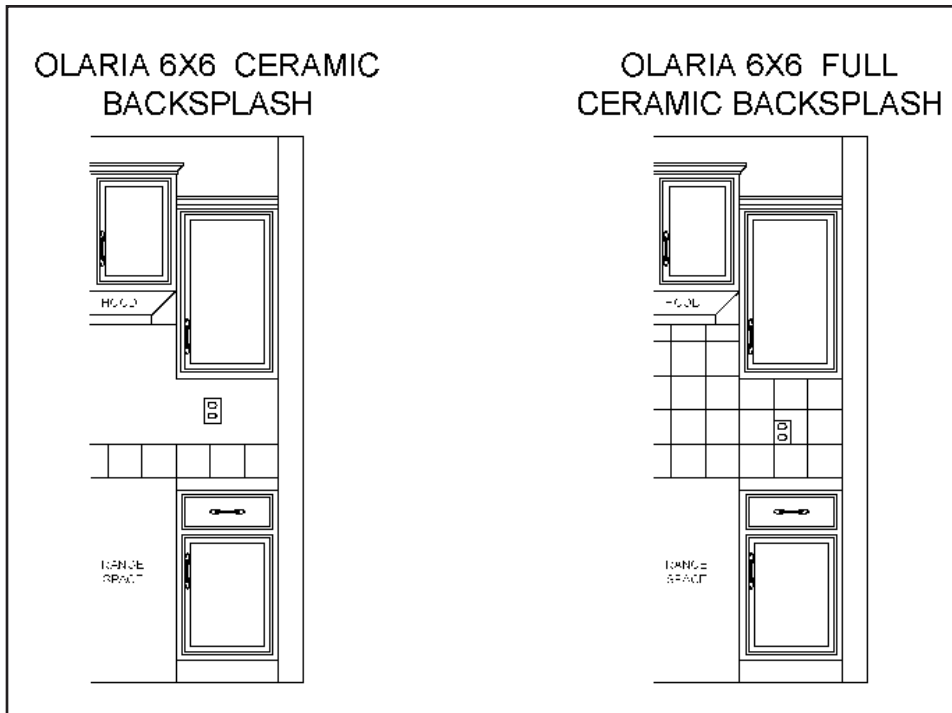
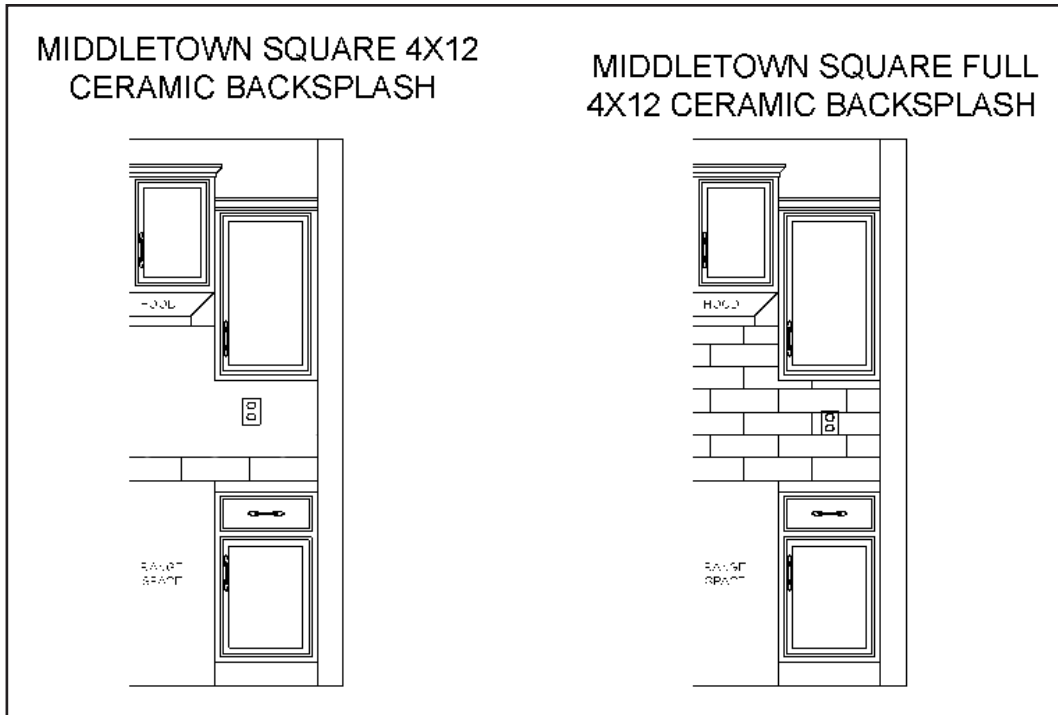



Half Sandstone Fireplace (Stone Mantel Only)
(N/A with Raised Hearth)



Full Grand Rapids Field Stone Fireplace
Half Grand Rapids Available

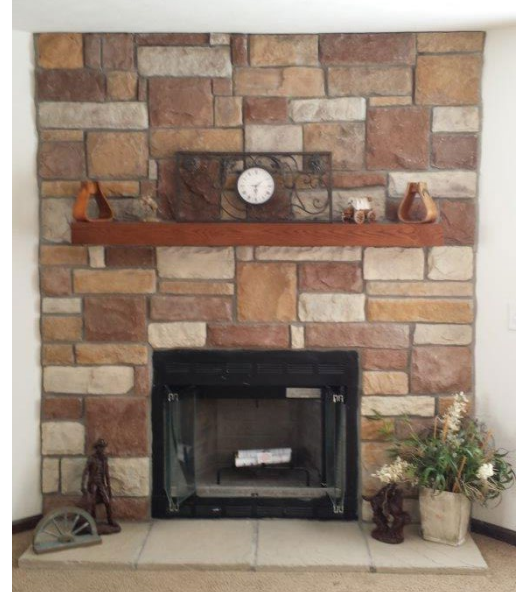

Full Amber Ashler Stone Fireplace
Half Amber Ashler Stone Fireplace Available



LED Fireplace Shown with Optional Shiplap Mirroflex N/A



LED Fireplace Entertainment Center with Shelves & Bench



Half Copperton Stackease Fireplace
Full Stackease Fireplace Available

BUILT-IN COMPONENTS

Commodore Homes offers a variety of accent cabinets to choose from and even more ways to combine them. Make your own combination(s) that best suits your lifestyle. Ask your home consultant for more details of our Built-In Components that are available.



1CO Double Rod Closet Organizer



5CO Sweater Closet Organizer with Drawers



7CO Corner Sweater Closet Organizer with Shoe Rack



- AC188415-1 Locker
(2 Shown Left & Right)
- ZAC188415-4 Storage Cabinet (Center)



Under the Stair Options

- Bench (*shown*)
- Hutch
- Desk
- Beverage Center

BATHROOMS



Tranquility Bath

Includes: 4x8 Ceramic Shower with Tile Accent, Ceiling Mount Rainfall Shower Head, Wall Mount Adjustable Shower Head, 2 LED Surface Mount Lights over Shower, 72" Oasis Tub, 2 LED Surface Mount Lights over Tub, Double Lav, Ceramic Backsplash, Enclosed Privacy Commode, Ledge with Linen Overhead Cabinet Behind Stool (select Models) and Linen Cabinet or Linen Closet

Note: Cabinet & Ceramic choices have changed. Please see page 3 for Cabinet styles/colors available and page 7 for ceramic styles/colors available. See page 11 for mirror options.

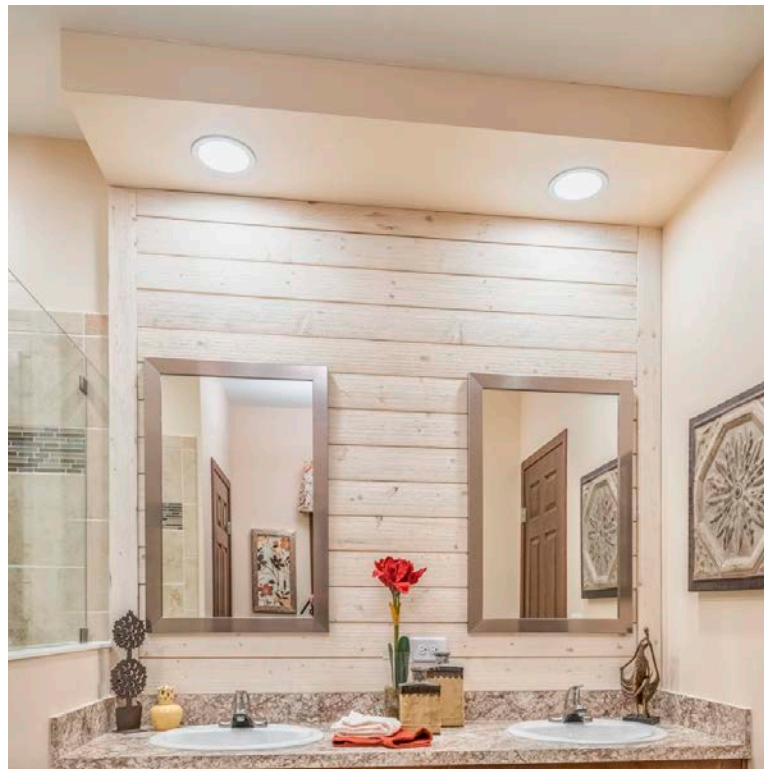

Soffit with Lights and Ship Lap Accent



ZTT2132 Linen Cabinet Over Commode



Black Framed Mirror



LED Black Framed Mirror



Twin Towers in Bath



Square Sink



3/4 Wall at Shower on 4'x6' and 4'x8' Showers (Shown with optional Shiplap. Standard drywall with hooks)



ZMO-209 Recessed Medicine Cabinet with Solid Door or Mirror



Medicine Cabinet
3 Door Also Available

TUBS & SHOWERS



Oasis Tub



Free Standing Tub



49" Corner Shower
*Where Available and Shown
with Optional Transom*



60" Garden Tub 60 x 42



54" or 60" Shower - *Where
Available and Shown with Optional
Transom window*



*Tranquility Shower Includes: 4'x8' Ceramic Tile Shower
with Accent, Ceiling Mount Rainfall Shower Head,
Adjustable Hand-held Shower Head and 2 LED Surface
Mount Lights*



48" Ceramic Tile Shower
with Bench



48" Ceramic Tile Shower with
Bench and 2 Sided Glass
Enclosure on Wall Ledger



Curved Shower Curtain Rod
(Included in Drapery Package)
Available in Brushed Nickel Only

Note: Ceramic Tile Patterns and Sizes have changed. Please see your Representative for current patterns and colors.

Shower Doors Available in Brushed Nickel Only



4' x 6' Ceramic Walk-in Shower
*Includes: Ceiling Mount Rainfall Shower
Head, Adjustable Hand-held Shower
Head and 2 LED Surface Mount Lights*



54" Ceramic Shower with or
without Seat *Where Available and
Includes Glass Doors*



30"x60" Accessible Shower
*Includes: 3/4" threshold, grab bars,
folding seat and hand held shower*

INTERIOR FAUCETS

All Available in Brushed Nickel or Black



Standard Kitchen or
Utility Sink Faucet



Pull-Down Gooseneck
Kitchen Faucet



Coil Spring
Faucet



Soaker Tub Faucet



Bath Lavatory Faucet



Waterfall Bath
Lavatory Faucet



Adjustable Hand-Held
Shower Head



Wall Mount Rainfall
Shower Head



Tub/Shower Spout



Shower Head and
Diverter



Customize Your Dream Home!



EXTERIOR



BATH



KITCHEN

Customize your dream home colors to see what your house could look like. The exterior InHouse experience allows you to select a Roof Pitch with a Dormer, Siding Color, Shingle Color, Trim Color, Shake Siding, Vertical Siding to get an idea for what your home could look like with the color scheme you have selected.

The InHouse experience gives you the opportunity to design your dream Bathroom or Kitchen. Selections range from your countertop colors, cabinet colors, vinyl floor color, appliances, even down to your kitchen sink!

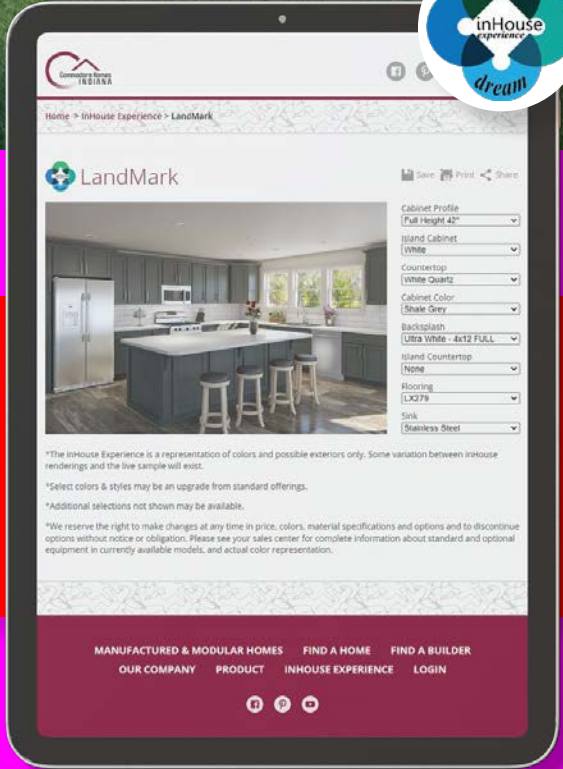

INTERIOR LIGHTING



2-Light Bath Vanity Fixture
Available in Brushed Nickel or Matte Black



5-Arm Chandelier
Available in Matte Black Only



4-Light Open Cage Light
Available in Matte Black Only



Stem Light
Available in Brushed Nickel or Matte Black



Corded Globe Pendant Light
Available in Matte Black or Black/Gold



White Paddle Fan with White Blades



USB Recept



LED Surface Mount Can Light
Where available



Gatsby Exterior Light

DOORS & TRIM



White 2-Panel Door
*Available in Hollow Core or Solid Core
Also Available in Stained French Country &
Natural Stained*



Sliding Barn Door
Available in White or Grey



Lever Passage Set
Brushed Nickel Only

Stained Wood Interior Package (French Country & Natural)

- Stained Wood Door & Window Casings, Door & Window Jambs & Baseboard Moulding
- Stained 2-panel Solid Wood Doors
- Stained Wood Door and Window Jambs

WALLS & ENTERTAINMENT CENTERS



Glo and Sto Wall Includes: Entertainment center, Led fireplace, 6" LED Lights, 2 computer jack recept combos and Drawers/Storage on bedroom side. (see CAD drawing below)

*Shiplap accent separate option

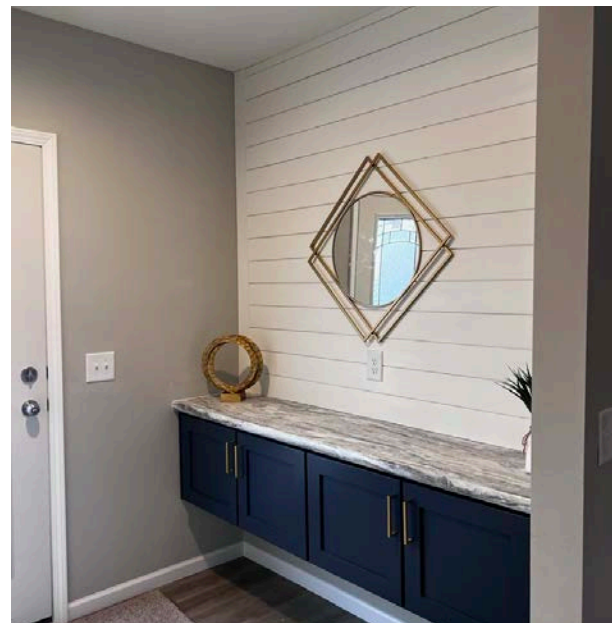
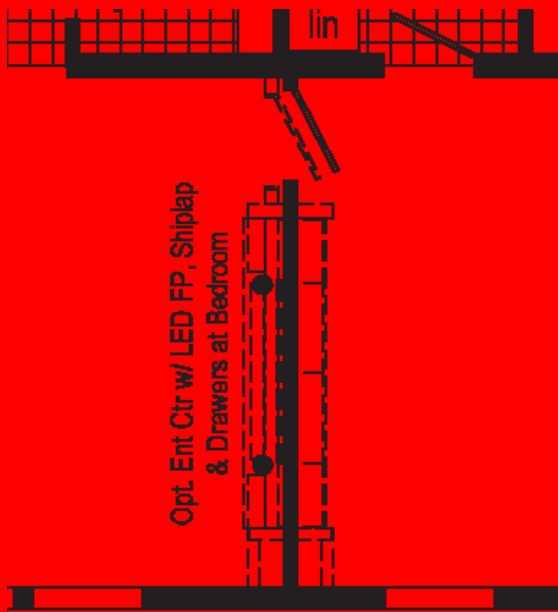

Ship Lap Accent Wall
Colors Available: Grey and White



Entertainment Wall
Includes: Bumpout, Cabinets, 2 - Casement Windows, Entertainment Center and 3 Can Lights. Where Available Replacing 2 Windows



MF-472A Drywall Recessed TV Center
Includes: Light Soffits and Ship Lap Accents

UTILITY ROOM



Laundry Center ZMF-413
Washer and Dryer Shown are N/A



Laundry Bench
Where Available: 30", 39" & 51"



Boot Bench
Where Available: 30", 36", 48", 54" & 60"



ZMO-89 Utility 30" Overhead Cabinets



Utility Sink - Where Available and Standard in some models

ATTIC ACCESS, CEILINGS, & SOFFITS



Walk-Up Attic

- Available with 6.98/12 & 9/12 (Mod only) Roof Pitch and 8' Flat Ceilings.
- Collar Ties Required (collar ties varies - 2x4 and 2x6)
- Half Walls & Plastic Done on-site by Others

Attic Stairs for Walk-Up Attic
(Includes Solid Door with Sweep)



Century Cabinet Crown and Soffit



Inset Tray Ceiling - Where Available
Ceiling Cove N/A



Drywall Tray Ceiling - Where Available
Ceiling Cove N/A

Available Ceiling Heights
8' Flat, 8'6" Flat, 9' Flat, 7'-6" Cathedral



Finished Ceiling Joint



Rounded Archway

SIDING & PORCHES



Shown with: 6.98/12 Roof, 27'-4" Twin Peak Dormer with Bumpout, Round Top Front Door Discontinued - See Page 8 for Selections, Sidelite, Window Lineals, Vertical and Shake Siding Accent and Garage (Built on-site by others)

- **Std. Dutch Lap Siding**
Colors Available: White, Country Beige, Driftwood, Cypress, Clay, and Greystone
- **Market Square Dutch Lap Siding**
Colors Available: Lighthouse Red, Graphite, Slate, and Indigo
- **Craneboard Siding R-4 (Double 7")**
Colors Available: Country Beige, Clay, Driftwood, White, and Cypress
- **Craneboard Siding (Double 7") Market Square**
Colors Available: Lighthouse Red, Graphite, and Slate
- **Smart Lap Siding**
Colors Available: Chesapeake Blue, Cobble Brown, Driftwood, Cypress Moss, and Cape Cod
Trim Colors Available: Extra White and Sand Castle
- **Smart Lap Vertical Siding Accent:**
Colors Available: Driftwood, Sandcastle, and White
- **Vinyl Shake Accent**
Colors Available: White, Clay and Black Walnut
- **Vertical Siding Accent**
Colors Available: Clay, White Birch and Greystone
- **Clay Package**
Includes: Low-E Argon Windows, Fiberglass 6-panel Front Door, Fiberglass 6-panel Rear Door, Coordinating Facia and Soffit *Clay Windows N/A in Double Hung
- **Raised Panel Shutters**
Colors Available: Burgundy, White, Brown, Clay, Grey, and Black
- **Window Lineals**
Colors Available: White and Clay
- **Architectural Shingles**
Colors Available: Driftwood, Onyx Black, and Estate Gray



12' Porch - Available on 28 Wide & 32 Wide - 8' porch Also Available (*steps and railings done on site by others*)



12' Deck - Available only on the 2LM2007P

EXTERIOR DOORS



6-Panel Front Door
(standard)



4-Lite with Glass
(Available Also in Stained wood)



Full View & 2-Panel with 1/2 Glass
Door with Internal Blinds



2-Panel Half Lite Element Glass



Full Lite Element Glass *(Available Also in Stained wood)*



Swing Patio Door with
Adjustable Internal Blinds



6' Vinyl Sliding Glass Door



10' Vinyl Sliding Glass Door
Where Available

WINDOWS

SINGLE AND DOUBLE HUNG WINDOWS

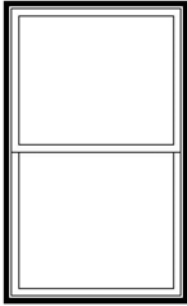

NO GRID

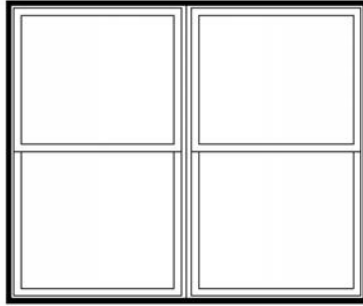

MULLED WINDOWS

Single Hung Double Pane Double Low-E Windows Available in:
 • White • Clay

Double Hung Triple Pane Low-E Windows Available in:
 • White

Casement Windows Available in:
 • White • Clay

CASEMENT WINDOWS



NO GRID

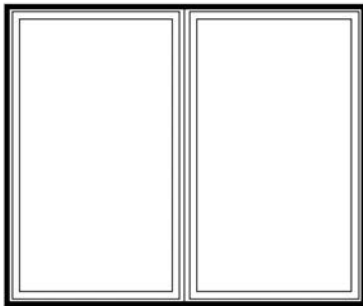

MULLED WINDOWS

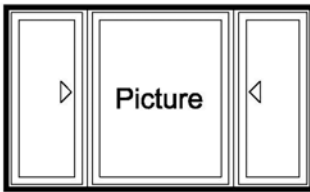

Picture Window
60" X 36"

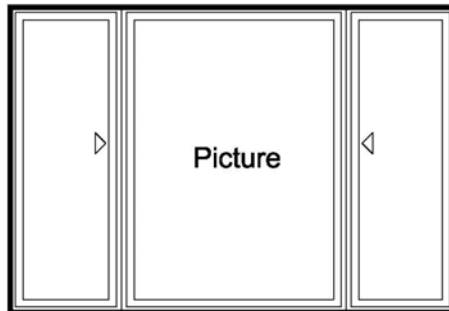

Picture Window
88" X 60"

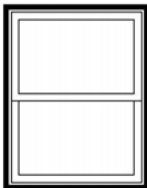

2430
28" X 36"

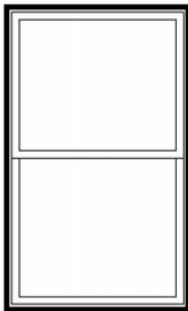

3050
36" X 60"

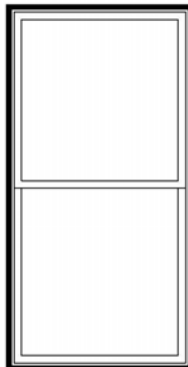

3060
36" X 72"

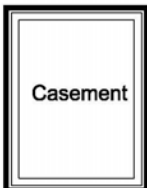

2430
28" X 36"

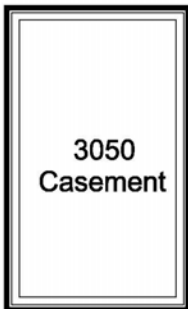

3050
36" X 60"

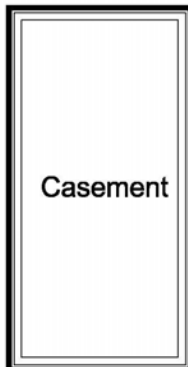

3060
36" X 72"

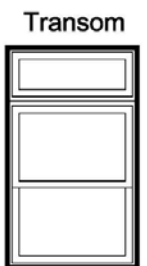

2430
28" X 48"

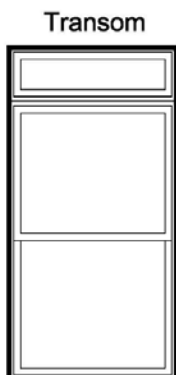

3050
36" X 72"

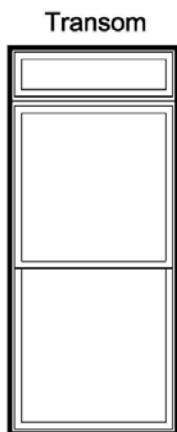

3060
36" X 84"

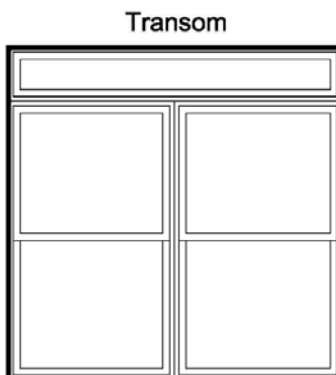

3050 MULLED
72" X 72"



3009 Transom
36" X 9"

Tub



4410 Transom
52" X 12"

**4x6
Shower**



5710 Transom
67" X 12"

Endwall

CHALET TRAPEZOID WINDOWS

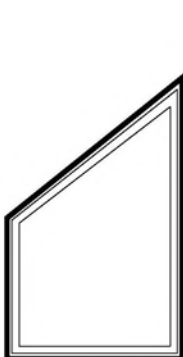

30410
36" X 58"



3060
36" X 72"



3060
36" X 72"

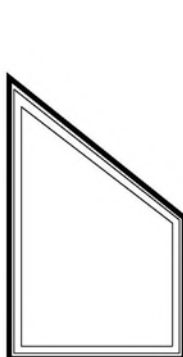

30410
36" X 58"

***Various Other Sizes Available over
Exterior Doors.**

DORMERS

**Note: Window Grids N/A*



22' Flush Dormer

Available in: Fixed, 5/12, 6.98/12 & 9/12 Roofs



27'-4" Twin Peak Dormer

Available in: 5/12, 6.98/12 & 9/12 Roofs



10' Flush Dormer

Available in: Fixed, 5/12, 6.98/12 & 9/12 Roofs



22' Twin Peak Dormer with Box Bay

Available in: 5/12, 6.98/12 & 9/12 Roofs

*Note: Window Grids N/A



Twin Eave at Dormer with Full Eave
Available with: 22' & 27'-4" Flush Dormers



Window with Egress for 9/12 Roof
Available with: 27'-4" Flush, Twin Peak or Twin Peak with Bumpout Dormers



10' Box Bay 74
Available in: 5/12, 6.98/12 & 9/12 Roofs



6' Cape Dormer (shown)
Available on 9/12 Roofs Only
4' False Dormer
Available on 6.98/12 & 9/12 Roofs Only



8' Cape Dormer Archtop N/A
Available on 9/12 Roofs Only



27'-4" Twin Bays
Available in: 5/12, 6.98/12 & 9/12 Roofs

OPTIONS

Guide

70
YEARS



Connect with Us:



www.commodore-in.com



www.commodore-in.com/inhouse-experience



1902 Century Drive
Goshen, IN 46528
574-971-3443

Your Independent Builder is:

Note: Because of varying state requirements and optional equipment, some or all of the utility locations may change per floor plan. (i.e. furnace, stairwell, etc.) Consult your factory representative for exact specifications.

Your purchase contract including options is with your retailer who is an independent contractor, not our agent, and is responsible totally for any alterations, exchanges, additions or attachments made in or to your home.
CH 4/23

All descriptive representations of the products on this brochure are believed to be correct at the time of publication. However, due to continued product improvement and changes in suppliers design and production, accuracy cannot be guaranteed. Therefore, equipment colors, material specifications, prices and model availability are subject to change without notice.
All information and images contained in this brochure are property of Commodore Homes and for the use by active dealers of the company only. ©